

PRIMELINE™

STUDIO CABINETS

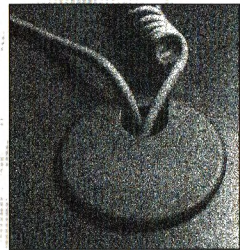
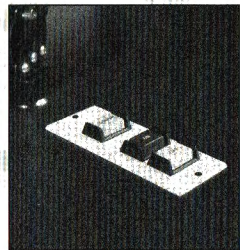
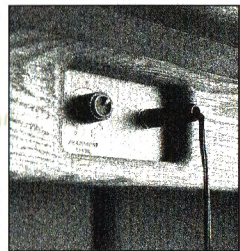
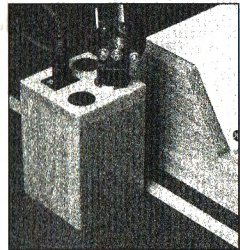
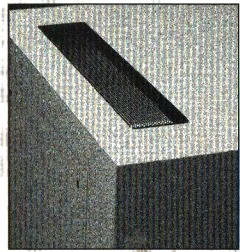

PACIFIC RESEARCH & ENGINEERING

If You Didn't Get This From My Site,
Then It Was Stolen From...
www.SteamPoweredRadio.Com



QUALITY

THERE ARE HUNDREDS OF REASONS WHY WE ARE INTRODUCING PRIME LINE™ MODULAR BROADCAST STUDIO FURNITURE— ALL OF THEM CUSTOMERS.

SOME HAVE VERY LIMITED CAPITAL BUDGETS, BUT SIMPLY WON'T SETTLE FOR LESS THAN A PR&E CONSOLE— EVEN IF IT MEANS HOUSING IT IN CUT-RATE CABINETRY. OTHERS THINK THEY CAN ONLY AFFORD PR&E CONSOLES AND FURNITURE IF THEY INTEGRATE THE EQUIPMENT, WIRING AND FURNITURE THEMSELVES, WHICH OFTEN TAKES WEEKS OF VALUABLE OR NON-EXISTENT IN-HOUSE ENGINEERING TIME. STILL OTHERS ARE MAKING SIMPLE RENOVATIONS OR ADDITIONS TO STANDARD-SIZE ROOMS THAT JUST DON'T REQUIRE A CUSTOM PR&E INSTALLATION. YET THEY DEMAND THE CRAFTSMANSHIP FOR WHICH PR&E IS FAMOUS.

SO AS THE PREMIER PROVIDER OF STATE-OF-THE-ART BROADCAST STUDIO SYSTEMS, WE SIMPLY SAW NO OTHER CHOICE. NOW, WITH PRIME LINE'S™ CLEVER "MANUFACTURABLE" DESIGN, EVEN THE MOST COST-CONSCIOUS STATION AND NETWORK MANAGERS CAN ENJOY THE CUSTOM-LEVEL CRAFTING AND QUALITY OF PR&E AT "STANDARD EQUIPMENT" PRICES. EVERY MADE-TO-ORDER CABINET IS EXCEPTIONALLY SOLID AND DURABLE, SOMETHING YOU'VE COME TO EXPECT FROM US, WITH STUDIO-PROVEN ERGONOMICS THAT REFLECT TWO DECADES OF RADIO INDUSTRY EXPERIENCE.

PLEASE TAKE A MOMENT TO REVIEW OUR NEW LINE. NOTE THE RICH SPECTRUM OF WOOD TRIM STAINS AND LAMINATE COLORS PRIME LINE™ OFFERS, AS WELL AS THE ATTENTION TO DETAIL THAT HAS BEEN A HALLMARK OF PR&E FOR OVER 25 YEARS. THEN COMPARE PRICES AGAINST COMPARABLE QUALITY OFFERINGS. WE BELIEVE YOU'LL BE SUITABLY IMPRESSED.

PACIFIC
RESEARCH
& ENGINEERING
IS COMMITTED
TO EXCELLENCE
IN MANUFACTURING,
CUSTOMER SERVICE
AND QUALITY.



www.SteamPoweredRadio.Com

PRIME LINE™
PACIFIC RESEARCH & ENGINEERING CORPORATION

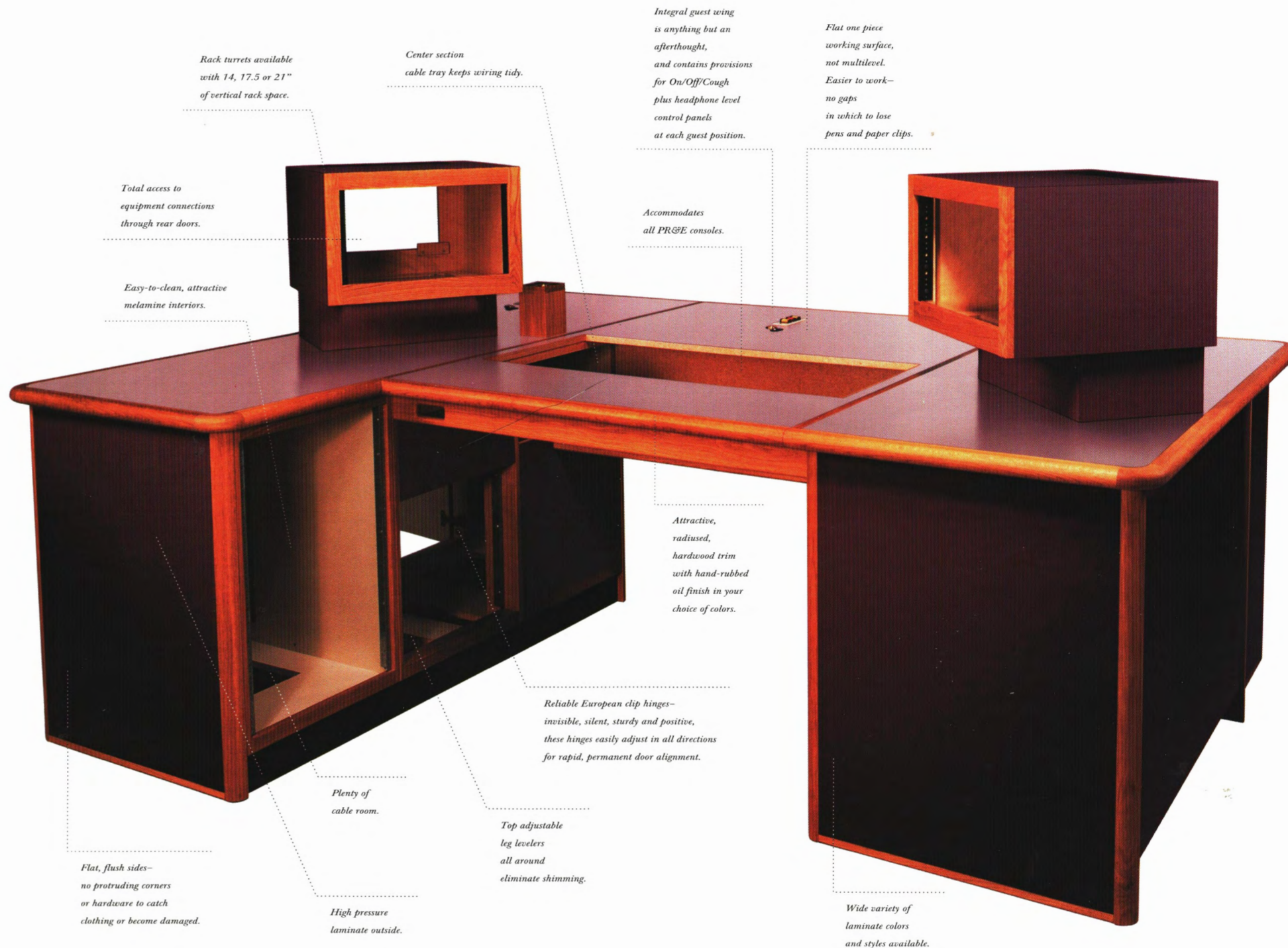

Rack turrets available with 14, 17.5 or 21" of vertical rack space.

Center section cable tray keeps wiring tidy.

Integral guest wing is anything but an afterthought, and contains provisions for On/Off/Cough plus headphone level control panels at each guest position.

Flat one piece working surface, not multilevel. Easier to work—no gaps in which to lose pens and paper clips.

Total access to equipment connections through rear doors.

Accommodates all PR&E consoles.

Easy-to-clean, attractive melamine interiors.

Attractive, radiused, hardwood trim with hand-rubbed oil finish in your choice of colors.

Reliable European clip hinges— invisible, silent, sturdy and positive, these hinges easily adjust in all directions for rapid, permanent door alignment.

Plenty of cable room.

Top adjustable leg levelers all around eliminate shimming.

Flat, flush sides— no protruding corners or hardware to catch clothing or become damaged.

High pressure laminate outside.

Wide variety of laminate colors and styles available.

TECHNOLOGY INTEGRATION

FLEXIBILITY

PRIMELINE'S™ MODULAR "BUILDING-BLOCK"

CONSTRUCTION ALLOWS EACH STUDIO TO

BE DESIGNED TO MEET A WIDE RANGE OF

SPACE AND FUNCTION REQUIREMENTS —

WITHOUT A CUSTOM PRICE TAG.



TO CONFIGURE A PRIMELINE™ SYSTEM FOR YOUR STUDIO, PLEASE CALL YOUR SALES REPRESENTATIVE AT 619.438.3911 AND TALK IT OVER.

WE'LL APPLY OVER TWO DECADES OF PROBLEM SOLVING TO HELP YOU FIND A SOLUTION THAT WORKS FOR YOU.



CONSTRUCTION DETAILS

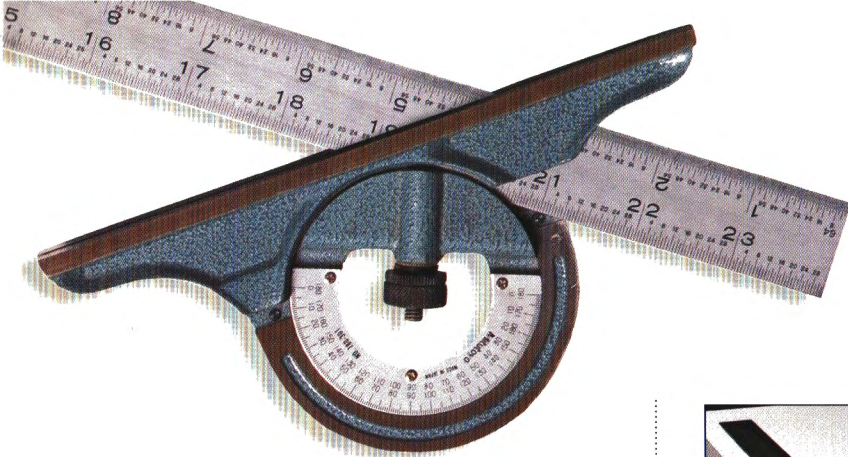

PR&E HAS TAKEN 25 YEARS

OF STUDIO DESIGN

EXPERIENCE AND

COMBINED FUNCTIONAL

ERGONOMICS WITH

MODULAR CONSTRUCTION

TECHNIQUES INTEGRATING

INNOVATIVE FEATURES

USUALLY FOUND ONLY IN

CUSTOM CABINETRY.

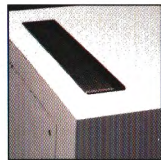
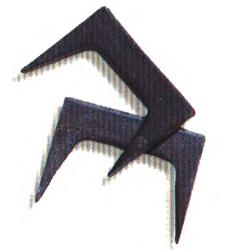

Top and bottom vents provided in all rack turrets.



Optional matching mic arm post, prewired and mounted.



Cutouts are provided for built-in, recessed headphone panels and other options.

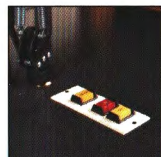

Full featured guest wings can be optionally equipped with pre-mounted on/off/cough button panels.



Worksurface cable grommets keep counter tops organized.

CLEAN LINES AND ONE-PIECE WORKING SURFACES CHARACTERIZE PRIMELINE™. HAND RUBBED HARDWOOD AT ALL CORNERS ELIMINATES THE CHIPPING CAUSED BY LAMINATE-TO-LAMINATE JOINTS, AND THE RADIUSD UPPER EDGE ON THE HORIZONTAL TRIM ADDS A SOFTNESS TO THE QUALITY APPEARANCE OF YOUR FURNITURE.



INTEGRATED "UNIBODY" GUEST WINGS TAKE A BEATING (OR A LEANING) BY YOUR MOST AGGRESSIVE GUESTS.



PRIMELINE™ USES ONLY SUPERIOR QUALITY CONSTRUCTION MATERIALS: HIGH PRESSURE LAMINATE OUTSIDE, AND EASY-TO-CLEAN, BRIGHT AND ATTRACTIVE MELAMINE COATED INTERIORS THROUGHOUT.



VERY LARGE CABLE ACCESS HOLES AND VERTICAL CABLEWAYS MAKE WIRING YOUR PRIMELINE™ SYSTEM A POSITIVE EXPERIENCE. TOP-ACCESSED LEVELING FEET KEEP YOU FROM LIFTING, GUESSING, TURNING AND DROPPING.



EURO CLIP HINGES PROVIDE SILENT OPERATION, POSITIVE CLOSURE WITHOUT LATCH, AND LONG SERVICE LIFE. DOORS SWING WIDE FOR EASY ACCESS TO EQUIPMENT REAR PANELS, AND ARE EASILY ADJUSTED IN ALL THREE DIRECTIONS FOR PERFECT DOOR ALIGNMENT.



PRIMELINE™ CABINETS ARE

MANUFACTURED WITH

QUALITY MATERIALS AND

HARDWARE TO WITHSTAND

YEARS OF SERVICE.

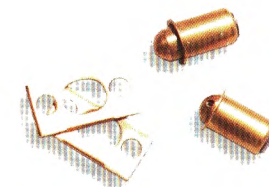

FINISH OPTIONS

PRIMELINE™ IS AVAILABLE IN SEVERAL PRE-SELECTED LAMINATE COLOR COMBINATIONS TO SUIT ANY DECOR. WHITE OAK HARDWOOD TRIM IS FINISHED WITH A COMPLIMENTARY HAND RUBBED, DANISH OIL FINISH, AVAILABLE IN A WIDE VARIETY OF STAIN COLORS.

CUSTOM LAMINATE COLORS AND WOOD FINISHES ARE AVAILABLE AT A NOMINAL CHARGE.



Iced Oak Oil Finish

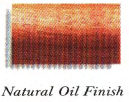

Natural Oil Finish

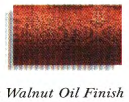

Dark Walnut Oil Finish

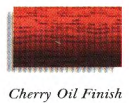

Cherry Oil Finish



Natural Gray Charcoal Matrix



Mallard Sage Matrix



Blue Wing Teal Teal Matrix



Marsala Red Amethyst Matrix



Raven Cinder Gray Matrix

ADDITIONAL OPTIONS

PR&E'S

COMBINATION OF

VISION, EXPERTISE,

MANUFACTURING

CAPABILITIES AND

TOTAL QUALITY

MANAGEMENT

WORK TO PROVIDE

YOU WITH THE

HIGHEST QUALITY

PRODUCT

AVAILABLE.

LET PR&E'S

EXPERIENCE WORK

FOR YOU.

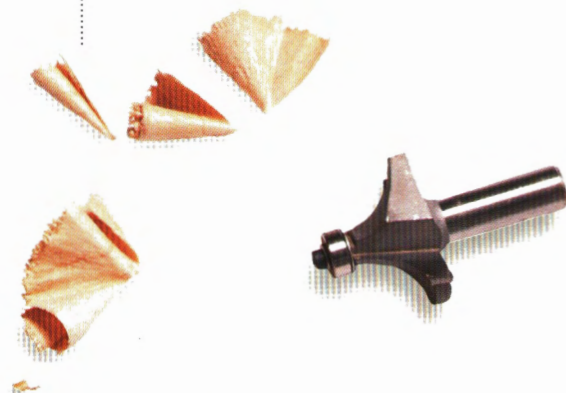

PRIMELINE™ STUDIO CABINETS FEATURES TOTAL MODULAR DESIGN FLEXIBILITY. COMBINATIONS OF BASIC BUILDING BLOCKS (CENTER SECTION, RETURNS & TURRETS), PLUS CUSTOM COMPONENTS MAY BE ORDERED FOR EACH ROOM.

AVAILABLE IN SIT-DOWN OR STAND-UP CONFIGURATIONS, WITH 21 INCHES OF RACK SPACE IN THE PEDESTAL UNITS OF THE SIT-DOWN, AND 28 INCHES IN THE PEDESTALS OF THE STAND-UP VERSIONS.

RACK BAY OVERBRIDGES—WITH 14 OR 21 INCHES OF VERTICAL SPACE, UP TO THREE ACROSS—CAN LEAVE THE COUNTER SPACE OPEN FOR DESKTOP EQUIPMENT, ETC.

CUSTOM CONSTRUCTION ESTIMATES QUOTED FOR SPECIAL ROOM SIZES OR UNIQUE REQUIREMENTS.

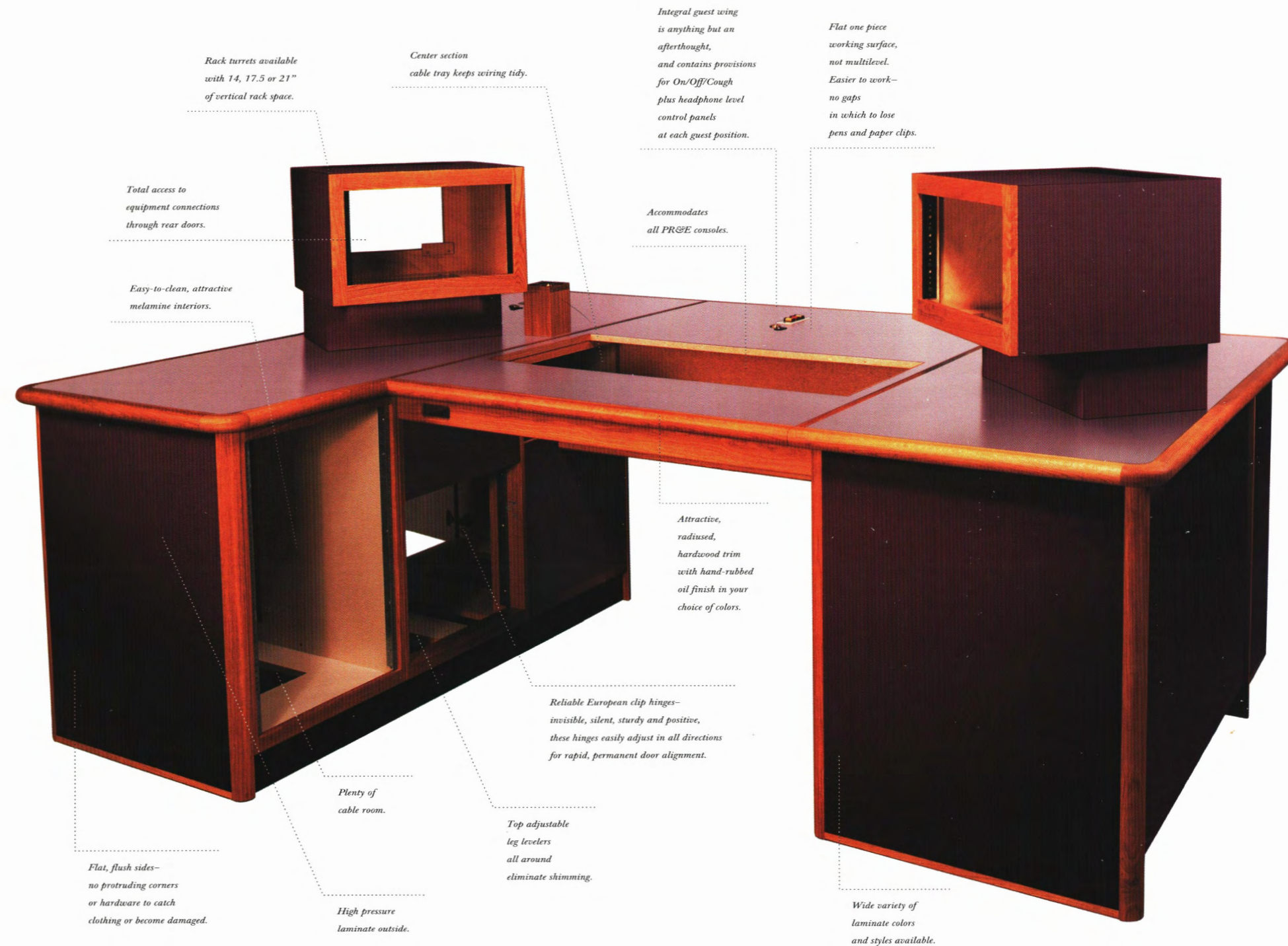

Rack turrets available with 14, 17.5 or 21" of vertical rack space.

Center section cable tray keeps wiring tidy.

Integral guest wing is anything but an afterthought, and contains provisions for On/Off/Cough plus headphone level control panels at each guest position.

Flat one piece working surface, not multilevel. Easier to work—no gaps in which to lose pens and paper clips.

Total access to equipment connections through rear doors.

Accommodates all PR&E consoles.

Easy-to-clean, attractive melamine interiors.

Attractive, radiused, hardwood trim with hand-rubbed oil finish in your choice of colors.

Reliable European clip hinges—invisible, silent, sturdy and positive, these hinges easily adjust in all directions for rapid, permanent door alignment.

Plenty of cable room.

Top adjustable leg levelers all around eliminate shimming.

Flat, flush sides—no protruding corners or hardware to catch clothing or become damaged.

High pressure laminate outside.

Wide variety of laminate colors and styles available.

TECHNOLOGY INTEGRATION

INSTALLATION

PRIMELINE™ ARRIVES WITH A COMPREHENSIVE SET OF ASSEMBLY DRAWINGS TO ASSIST WITH CABINET INSTALLATION AND ASSEMBLY.

ALL NECESSARY HARDWARE IS INCLUDED AND NO SPECIAL TOOLS ARE REQUIRED. AND SINCE PRIMELINE'S™ ACCESSORIES COME PREWIRED AND MOUNTED, NO ADDITIONAL WORK IS NEEDED TO PREPARE THE CABINET FOR EQUIPMENT INSTALLATION.

WIRING PRIMELINE™ IS JUST AS EASY. EACH PEDESTAL PROVIDES WIRING ACCESS THROUGH CONVENIENT ACCESS DOORS MOUNTED ON REMOVABLE EURO CLIP HINGES. TURRET BACKS ARE ALSO REMOVABLE FOR PERIPHERAL WIRING. PR&E EVEN OFFERS STANDARD WIRING PACKAGES, CONTACT YOUR REPRESENTATIVE FOR DETAILS.



WITH RUGGED
CONSTRUCTION
AND ELEGANT
LINES,
PRIMELINE™
REQUIRES NO
SPECIAL HARDWARE
OR TOOLS
TO ASSEMBLE.

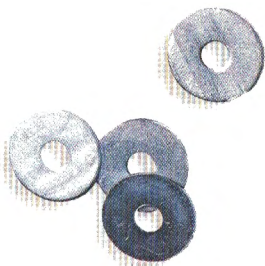

www.SteamPoweredRadio.Com



*Pacific Research & Engineering
Corporate Headquarters
Carlsbad, CA*

Since 1969, Pacific Research & Engineering has been designing and manufacturing premium-quality products for the most prestigious names in major market and network broadcasting.

PR&E continues its commitment to the industry with products that deliver long-term value to clients who appreciate the benefits of uncompromising quality.



WHERE GREAT RADIO BEGINS

PACIFIC RESEARCH & ENGINEERING CORPORATION
2070 LAS PALMAS DRIVE CARLSBAD, CA 92009 USA
GSA NO. GS.03F4064B E-MAIL: sales@pre.com
TELEPHONE: 619.438.3911 FACSIMILE: 619.438.9277
INTERNET: <http://www.pre.com>

PRIMELINE™

STUDIO CABINETRY

DIAGRAMS

DIMENSIONS

SPECIFICATIONS

PRODUCT WORKSHEET

CENTER SECTION WIDTHS

CONSOLE TYPE	DIMENSION "A" WIDTH	DIMENSION "B" CUT-OUT	DIMENSION "C" SETBACK
RMX-12	49 1/2"	19 1/8" x 30 3/4"	12"
RMX-20	49 1/2"	19 1/8" x 42 3/4"	12"
RMX-28	54 3/4"	19 1/8" x 54 3/4"	12"
PMX-20	49 1/2"	32 1/2" x 42 3/4"	2"
PMX-28	54 3/4"	32 1/2" x 54 3/4"	2"
BMXIII-18	49 1/2"	24 3/4" x 42 3/4"	12"
BMXIII-22	48 3/4"	24 3/4" x 48 3/4"	12"
BMXIII-26	54 3/4"	24 3/4" x 54 3/4"	12"
BMXIII-30	60 3/4"	24 3/4" x 60 3/4"	12"
BMXIII-34	66 3/4"	24 3/4" x 66 3/4"	12"
AMX-18	49 1/2"	29 3/8" x 42 3/4"	2"
AMX-22	48 3/4"	29 3/8" x 48 3/4"	2"
AMX-26	54 3/4"	29 3/8" x 54 3/4"	2"
AMX-30	60 3/4"	29 3/8" x 60 3/4"	2"
AMX-34	66 3/4"	29 3/8" x 66 3/4"	2"
ABX-26	54 3/4"	35 3/4" x 54 3/4"	2"
ABX-34	66 3/4"	35 3/4" x 66 3/4"	2"

Setback refers to the space between the front edge of the section unit and the front edge of the console cut-out.

Center section shown with no returns.

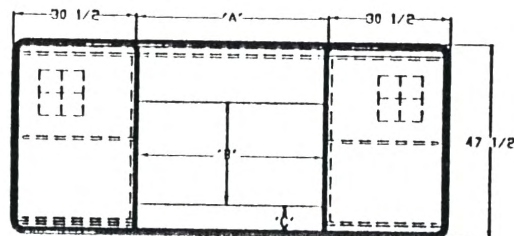

DIMENSIONS: CENTER SECTION WIDTHS

PrimeLine™ is available in a variety of standard center section widths, designed to accommodate all PR&E consoles.

Center section widths have been ergonomically designed to provide maximum operator comfort and convenience, while maintaining a sound, structural base to support the console.

Non-standard center section widths and cutouts are available at a nominal charge, allowing PrimeLine™ to house most popular consoles.

PRIMELINE™

STUDIO CABINETS

SPECIFICATIONS: SIT-DOWN CABINET

PrimeLine's™ sit-down cabinet features a 29" high counter-top. This is equivalent to a typical desk height providing comfortable seating for operator and guests. The softly rounded, solid wood trim eliminates sharp edges on the top and corners, enhancing the work environment.

Cutouts are provided for microphone control and headphone jack panels in standard locations, further simplifying user system installation.

PrimeLine™ cabinets all feature console pedestals with 17½" of rack space—equivalent to 10 EIA standard rack units. The rack rails in these ventilated areas are recessed making these the ideal location for console power supplies and monitor amplifiers. Left and right return cabinets each provide 21" of rack space (12 EIA rack units).

Counter-top rack turrets are available in several sizes:

- 14" – equivalent to 8 EIA RU's
- 17½" – equivalent to 10 EIA RU's
- 21" – equivalent to 12 EIA RU's.

Sit-down cabinet shown with guest wing option and single left return

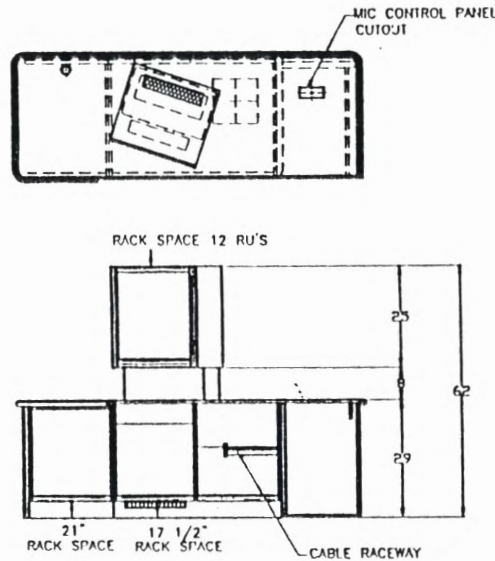

Sit-down cabinet shown with triple left return

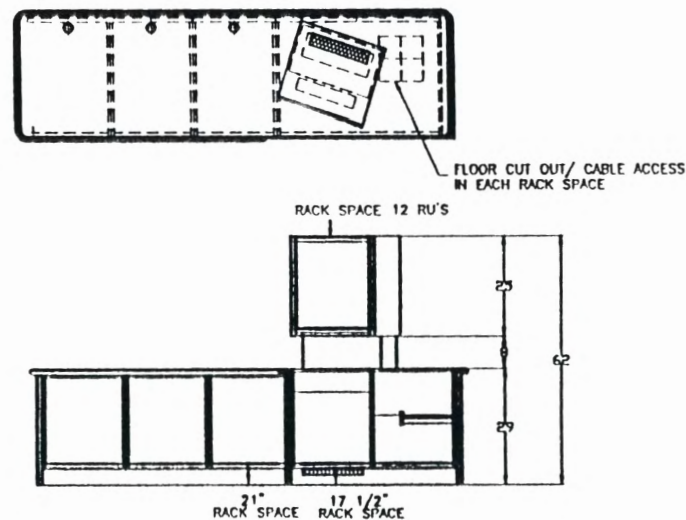

PRIMELINE™

STUDIO CABINETS

SPECIFICATIONS: STAND-UP CABINET

PrimeLine's™ stand-up cabinet features a 36½" high counter-top. This is the optimum height for stand-up operation. The softly rounded, solid wood trim eliminates sharp edges on the top and corners, further enhancing the work environment.

Cutouts are provided for microphone control and headphone jack panels in standard locations, further simplifying user system installation.

PrimeLine™ cabinets all feature console pedestals with 17½" of rack space—equivalent to 10 EIA standard rack units. The rack rails in these ventilated areas are recessed making these the ideal location for console power supplies and monitor amplifiers. Left and right return cabinets each provide 28" of rack space (16 EIA rack units).

Counter-top rack turrets are available in several sizes:

- 14"– equivalent to 8 EIA RU's
- 17½"– equivalent to 10 EIA RU's
- 21"– equivalent to 12 EIA RU's.

Stand-up cabinet shown with guest wing option and single left return

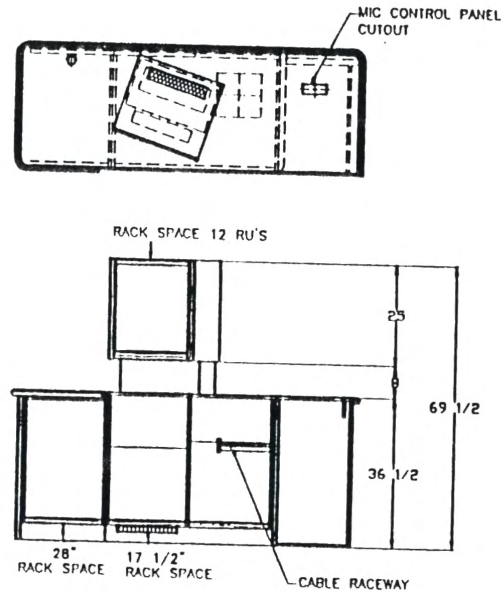

Stand-up cabinet shown with triple left return

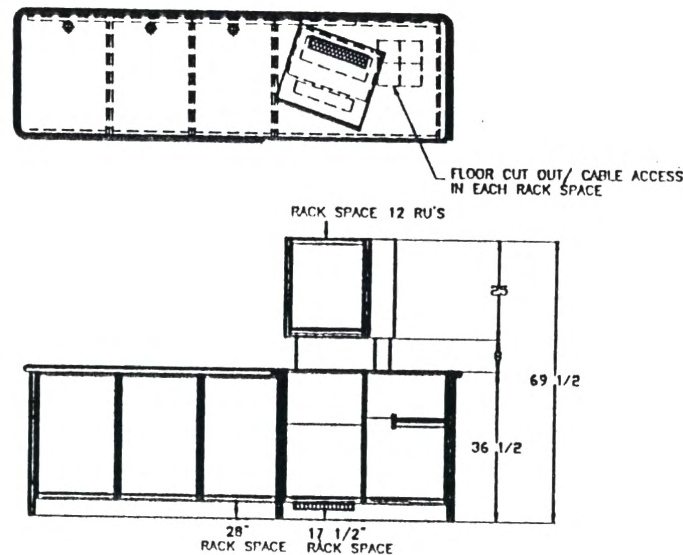

STANDARD FEATURES

All PrimeLine™ cabinets are equipped with the following standard features:

- Cutouts for headphone jack and microphone control panels in standard locations.
- Counter top cable grommets in each return section.
- Large cableway access cutouts in each pedestal base.
- Exterior cableway access provided on the end of the left and right returns for additional equipment needs.
- Rack turrets have top and bottom vents and removable back panels.
- Returns feature large access cableways and removable Euro-hinged doors.

The optional guest wing configuration features three guest positions, equipped with cutouts for mic control and headphone jack panels.

Illustration 1 shows cabinet with double left return and single right return

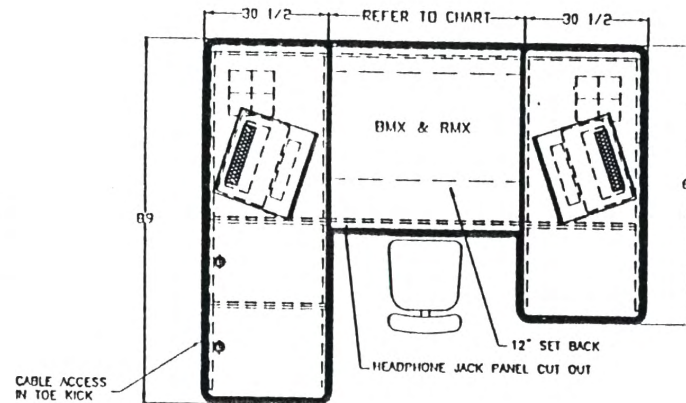
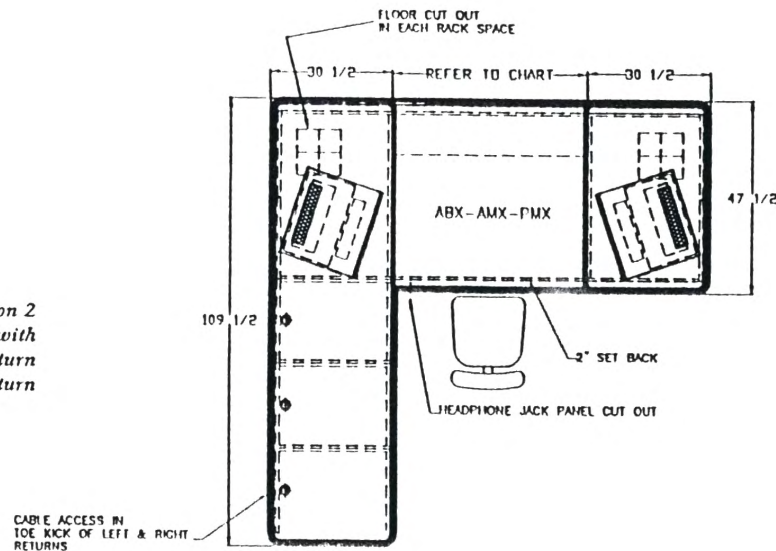

Illustration 2 shows cabinet with triple left return and no right return



PRIMELINE™

STUDIO CABINETRY

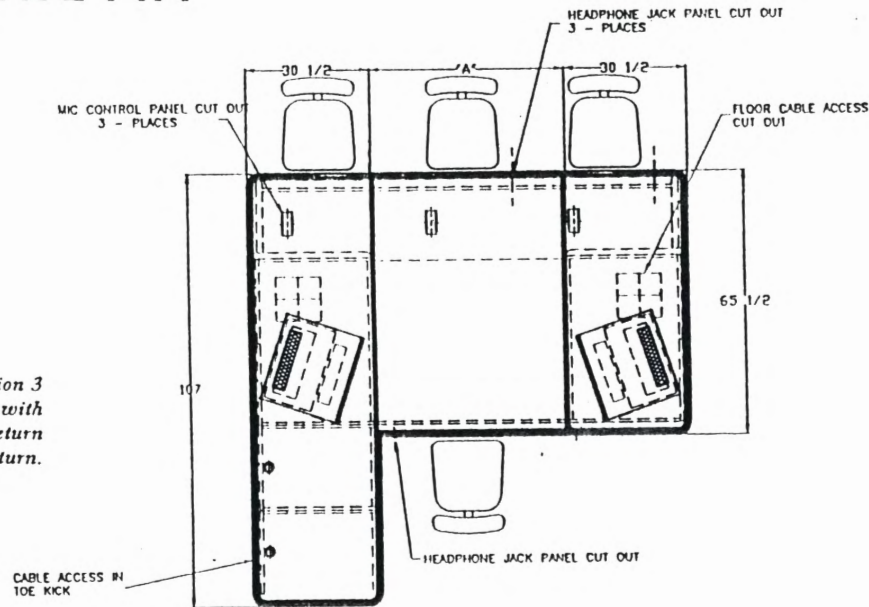

Illustration 3 shows cabinet with guest wing, double left return and no right return.

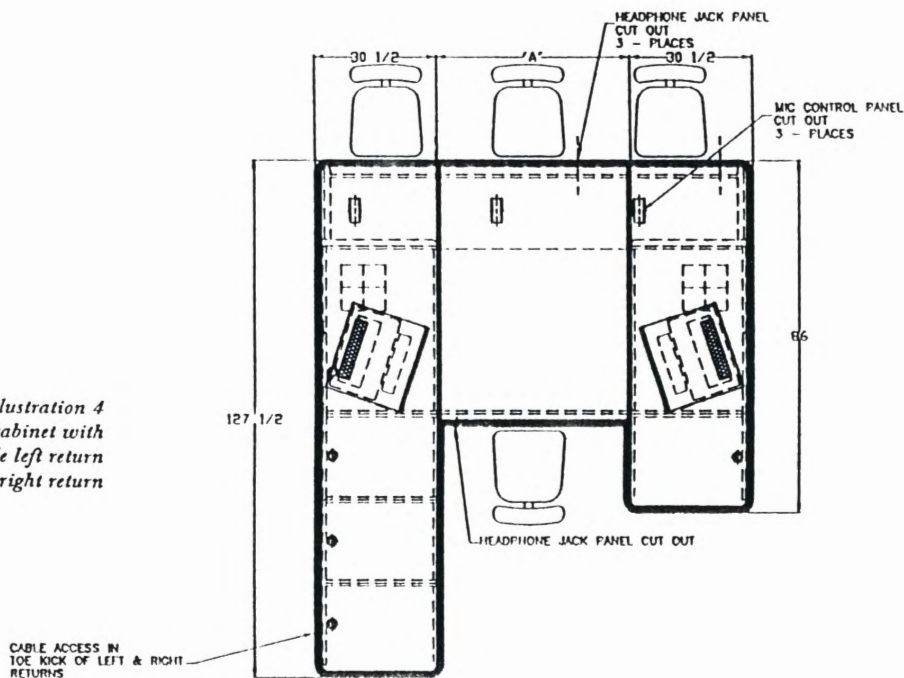

Illustration 4 shows cabinet with guest wing, triple left return and single right return

STANDARD DIMENSIONS

The following are standard PrimeLine™ dimensions:

Sit-Down Cabinet Height: 29"

Stand-Up Cabinet Height: 36 1/2"

Center Section Cabinet
Width: 61" plus dimension "A"
center section width
Depth: 47 1/2"

Rack Return, Right or Left
Width: 30 1/2"
Depth: 20 5/8" each, plus 1 1/2" for each
outside finished end panel

Rack Turret
Rack Space: optional 14", 17 1/2" or 21"
Riser height: 8"

Guest Wing
Width: 61" plus dimension "A"
center section width
Depth: 18"

Accompanying drawings show dimensions for typical configurations:

Illustration 1
Double left return & single right return
Width: 61" plus dimension "A"
center section width
Depth: left: 89"
right: 68"

Illustration 2
Triple left return and no right return
Width: 61" plus dimension "A"
center section width
Depth: left: 109 1/2"
right: 47 1/2"

Illustration 3
Guest wing with double left return & no right return
Width: 61" plus dimension "A"
center section width
Depth: left: 107"
right: 65 1/2"

Illustration 4
Guest wing with triple left return & single right return
Width: 61" plus dimension "A"
center section width
Depth: left: 127 1/2"
right: 86"

Sit-Down 29"

Stand-Up 36½"

Center Section

Center Width: _____

Console Type: _____

Guest Wing

Standard – opposite console operator

Non-Standard – side mount

Right

Left

Rack Returns

Left: Single Return

Double Return

Triple Return

Right: Single Return

Double Return

Triple Return

Right Rack Turret

Rack Space 14" 8 EIA RU's

17½" 10 EIA RU's

21" 12 EIA RU's

Other: _____

Riser Height: 8"

Other: _____

Left Rack Turret

Rack Space 14" 8 EIA RU's

17½" 10 EIA RU's

21" 12 EIA RU's

Other: _____

Riser Height: 8"

Other: _____

Laminate Color

Natural Gray/S-6-12T
Charcoal Matrix/MR-6-2T

Mallard Teal/S-3-43T
Sage Matrix/MR-5-3T

Bluewing Teal/S-3-37T
Teal Matrix/MR-3-2T

Marsala Red/S-1-47T
Amethyst Matrix/MR-1-4T

Raven/S-6-33T
Cinder Gray Matrix/MR-6-6T

Other: _____

Oil Finish Stain Colors For Standard

White Oak Trim:

Iced Oak

Natural

Dark Walnut

Cherry

Other: _____

NOTE: Headphone jack panel cutouts & counter-top cableway grommets are provided in standard locations as noted on the enclosed specification and dimension sheets.

Guest wing standard configuration accommodates three positions and includes cutouts for mic control panels and headphone jack panels.

Any deviations to standard placements may be marked in the "special requests" section.

Any such changes may be subject to a nominal charge. Please consult with your sales representative for details.

Special Requests:

Note any changes to standard equipment placement below, including all dimensional details.

Guest Wing		
Left Pedestal	Center Section	Right Pedestal
Left Return		Right Return
Left Return		Right Return

While PrimeLine™ addresses most traditional applications, it can also be enhanced with custom elements to meet more unique requirements. Call your sales representative for more information.

Some possible enhancements might include:

- Copy Stand(s)
- Microphone Arms
- Mic Arm Post(s) with mounting bushings and XLR connectors
- Overbridge-console or rack
- Turntable Return-covered or uncovered
- Tape Machine Cradle (also available with countertop mount)
- Computer Monitor Support Arm